

Join Us

Custom Lane
Connect,
Collaborate,
Create

Opening times

Monday-Friday 10am-5pm
Saturday 10am-5pm
Sunday 11am-4pm

Café opening times

Monday-Friday 8:30am-5pm
Saturday 10am-5pm
Sunday 11am-5pm

@ [custom_lane](#)

🐦 [customlaneleith](#)

→ [customlane.co](#)

Welcome

Custom Lane is a centre for design and making, featuring Studios¹, Exhibition² & Event Space³, Café⁴, Workshop⁵ & Retail⁶. We are developing opportunities and support for designers and makers to connect, collaborate, create.

1 Studios & Hot-Desks

We have a range of workspaces for long and short term lease, ranging from open studio bays and desks to more contained studio spaces.

2 Exhibition Space

Housing a core and partner programme of exhibitions focused around design in all forms. We welcome submissions for hiring the space through our partner programme.

3 Event Space

Host to a range of public, private and design based events. Our 115 sqm events space can be open or closed off from our café and exhibitions.

4 Williams & Johnson Café

Open 7 days a week, our Café is run by specialist coffee roasters Williams & Johnson serving up high quality coffee and fresh locally baked goods.

5 Workshop

Home to social enterprise Edinburgh Tool Library and the GRAS fabrication team, available for professional design and build. The workshop is also available to our members.

6 The Cruiser Store

Kestin Hare's Edinburgh flagship, housing two floors of menswear and gifts alongside their own collection and a select edit of Made in the UK brands.

Become a Member

Join our community of [architects](#), [designers](#), [photographers](#) and [makers](#) and access our exhibition and event space, recently home to a range of international talent and organisations, from Tom Pigeon and Mella Shaw, to the [British Council](#) and [Craft Scotland](#).

We will soon be launching a Friends of Custom Lane membership package that will give members exclusive invites and discounted tickets to Custom Lane events, like our monthly [Talks at the Lane](#) series, as well as preview invites to [exhibitions](#), [events](#) and [parties](#).

Custom Lane residents can [refer a friend](#) for a fixed desk and receive £100 off your next bill. Even more reason to be part of our community.

Co-worker benefits

Day Passes

Hot-Desk

Studio / Premium

Co-worker benefits	Day Passes	Hot-Desk	Studio / Premium
Reception / postal services	•	•	•
Free tea and coffee		•	•
50% off space & meeting room hire		•	•
20% discount at W&J Café		•	•
20% off Kestin Hare (10% sale items)		•	•
20% off Custom Lane gallery & retail		•	•
20% off printing / 3d printing / VR	•	•	•
20% off on fabrication team services		•	•
20% off on-site car parking		•	•
20% off talks, workshops & events	•	•	•
Tool Library Access (4000+ tools)		•	•
Tool Library Workshop Sessions (2 p/w)		•	•

Ground Floor

Dock Place

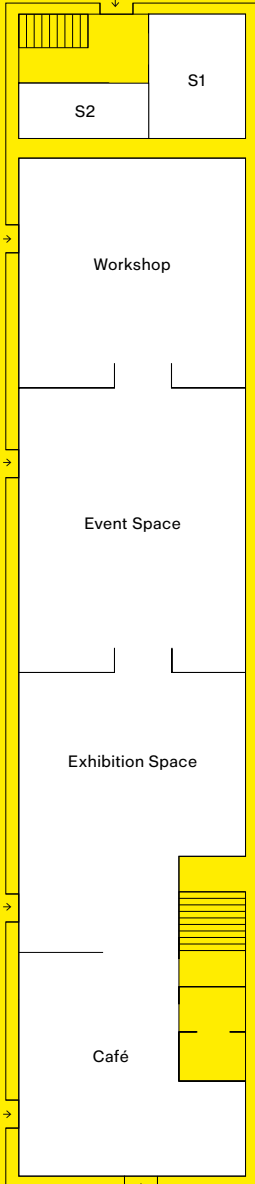

Exhibition, Event & Retail Hire

Our exhibition and event space houses a curated core and partner programme focused around design in all forms. Our reception area is also available to lease to showcase your brand or product. Submissions for hiring our spaces are welcome – hourly rates available.

Event Space 90m²

AM 9-1	PM 1-5	Day 9-5	Eve 5-9	Week	Month
£145	£145	£180	£145	£845	£2700

Exhibition Space 65m²

AM 9-1	PM 1-5	Day 9-5	Eve 5-9	Week	Month
£105	£105	£130	£105	£610	£1950

Reception Retail Various m² available

Day	Week	Month
£25	POA	POA

Our meeting room is a desirable place to hold meetings, presentations or more practical workshops and photoshoots. Seats up to 16 people.

Meeting Room 21m²

AM 9-1	PM 1-5	Day 9-5	Eve 5-9	Week	Month
£35	£35	£50	£35	£205	£630

Workshop and Fabrication

Our workshop is home to our in-house design and build team and can be accessed by members of Custom Lane.

Workshop Access

Day 9-5	5 Day	Month	Out of hours
£10	£45	£200	£100

Dedicated bench £275 per month

First Floor

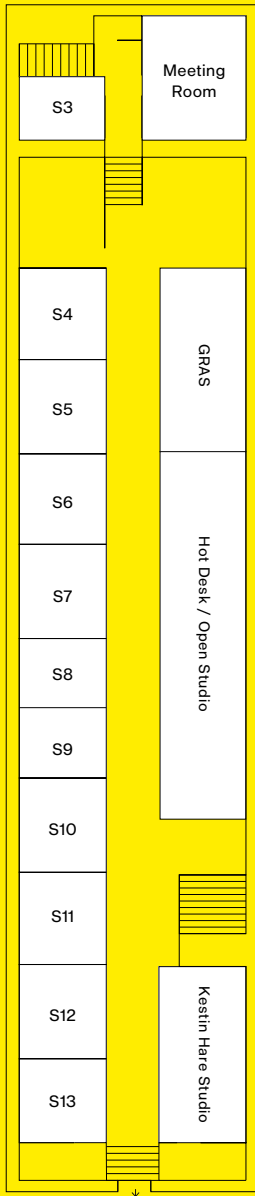

Studios & Co-working

Our studios and co-working areas are home to designers, makers, creators and thinkers from a range of creative disciplines across our studio bays and on-demand co-working areas.

Studios / Studio Bays [Various m²](#)

Studio sizes range from 9-18m². If you would like to apply for a studio space at Custom Lane, email hello@customlane.co

Hot Desk

Day 9-5	5 Day	Month
£10	£45	£180

Premium Desk

Fixed Desk	£250 per month
Lockable Desk	£300 per month

Studio Optional Extras

On-site parking	£15 per day / £150 per month
Lockable storage	£10 per month
1000mbs internet	£15 per month
Dedicated LAN	POA

Studios / Studio Bays [Various m²](#)

Studio sizes range from 9-18m². If you would like to apply for a studio space at Custom Lane, email hello@customlane.co

Hot Desk

Day 9-5	5 Day	Month
£10	£45	£180

Premium Desk

Fixed Desk	£250 per month
Lockable Desk	£300 per month

Studio Optional Extras

On-site parking	£15 per day / £150 per month
Lockable storage	£10 per month
1000mbs internet	£15 per month
Dedicated LAN	POA

All lease prices are inclusive of VAT and a service charge for the following: maintenance of the premises; electrical, plumbing, heating and lighting, cleaning, WIFI and event access.

Where to find us

We are based in the heart of Leith's scenic waterside shore, a central hub of Edinburgh's creative talent. The buzzing port district is home to a diverse range of creative organisations, production agencies and artists' studios.

At the heart of our organisation is collaboration. Whether you are based in our workspace, or hiring our multi-use exhibition and event space, we strive to work with you to extend opportunities and achieve the highest quality outcome across all projects.

If you have any questions or would like to book a tour, please call [0131 510 7571](tel:01315107571) or email hello@customlane.co.



Custom Lane
Custom Wharf
67 Commercial Street
Leith, Edinburgh
EH6 6LH

email: hello@customlane.co
visit: customlane.co
tel: [0131 510 7571](tel:01315107571)